

MONACO

The Monaco is an aesthetically pleasing versatile, rotational emergency exit luminaire with conventional functionality plus extra performance and styling provided by the Evaclite ADS Adaptivec/Dynamic LED 3PA Blade technology.

Installation is ideal for walls or ceilings.



1: ALARM
PASSIVE SIGN



2: ALARM EVENT
DYNAMIC SIGN FOR
SAFE EXIT

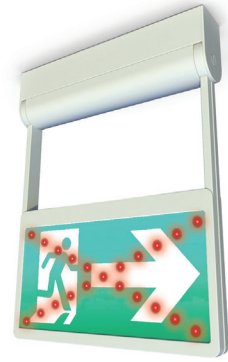

3: ALARM EVENT
ADAPTIVE SIGN FOR
UNSAFE EXIT

Available in standard white housing and also in brass or chrome effect finishes.



IP20



ADS

2 Year
WARRANTY

KEY FEATURES:

- ➔ Complies with BS5266-1 and conforms to EN60598.2.22 with IEC 60598-12014, ISO 30061, ISO 3864-1 & ISO 3864-4.
- ➔ Aluminium body suitable for use on ceilings or walls.
- ➔ Long life SMD > 54,000+ hour LED version.
- ➔ Suitable for single or double-sided use.
- ➔ Available in self-contained AC/DC with 3 hour back-up battery.

EVACLITE

Bisley Two
Knightway House
Park Street
Bagshot, Surrey
GU19 5AQ

Email:

info@evaclite.com

Phone:

T. 01633 404999

Visit:

www.evaclite.com

SPECIFICATION

Self-contained Dynamic edge-lit exit sign utilising an LED light source. Aluminium body suitable for use in ceiling or walls. ISO legend illumination compliant with the requirements of EN1838. Luminaire compliant to EN60598-2-22, ISO 30061, ISO 3864-1 & ISO 3864-4.

FIRE ALARM PANEL CONNECTIVITY

The Monaco Dynamic Exit Sign provides 2 x open volt free contacts and can be activated via a loop powered input/output relay module, supplied by your preferred choice of fire alarm panel manufacturer.

LAMP

Maintained State: <6W LED strip
 Dynamic State: <7W LED arrays
 Supply Voltage: 230v - 50Hz

MATERIALS

- Aluminium

BATTERY (self-contained versions)

4.8v 2100mAh Nimh

INSTALLATION NOTES

Can be installed onto solid walls or ceilings.

SYSTEM MODE (LED)

Maintained

TRIM

White as standard

TRIM OPTIONS

- /BRS Brass
- /CHR Chrome

WEIGHT

<3kg

DIMENSIONS (mm)

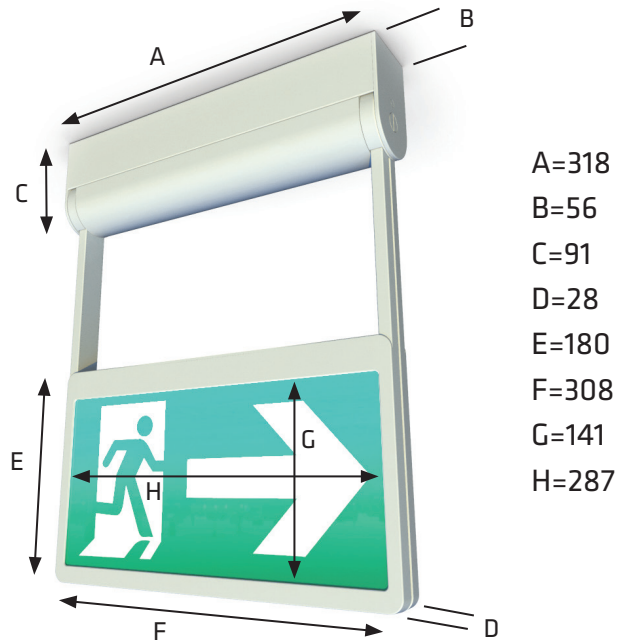

MAXIMUM VIEWING DISTANCE

Viewing distance of exit sign: 24 metres

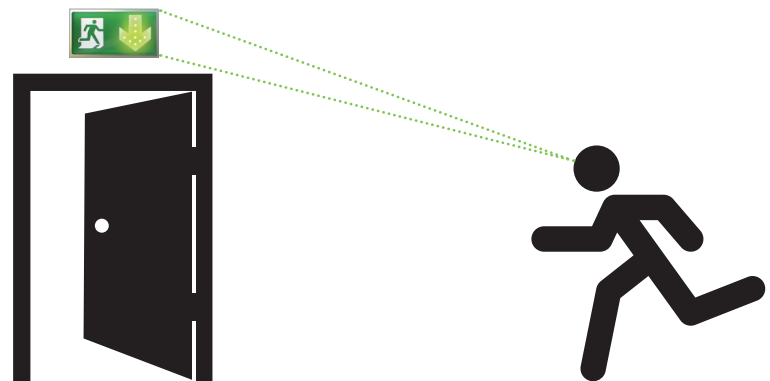

LEGEND PANEL

Legend Panel	ISO Pictogram	Cat no
Single sided arrow up		MON/ADS/S/24/AU
Single sided arrow down		MON/ADS/S/24/AD
Single sided arrow left		MON/ADS/S/24/AL
Single sided arrow right		MON/ADS/S/24/AR
Double sided arrow left & right		MON/ADS/S/24/ALR
Double sided arrow up		MON/ADS/S/24/AU
Double sided arrow down		MON/ADS/S/24/AD