

BARCELONA

The Barcelona is a robust IP65 rated maintained exit sign with conventional functionality plus extra performance and styling provided by the Evaclite ADS Adaptive/Dynamic LED 3PA Blade technology. Installation ideal for exterior walls and can be used internally.

Six screws fittings for the fascia allow easy access for installation & commissioning. Suitable for car parks, sports stadiums, airport concourse entrances, rail terminals, industrial premises, office buildings and construction sites.



1: ALARM
PASSIVE SIGN

2: ALARM EVENT
DYNAMIC SIGN FOR
SAFE EXIT

3: ALARM EVENT
ADAPTIVE SIGN FOR
UNSAFE EXIT

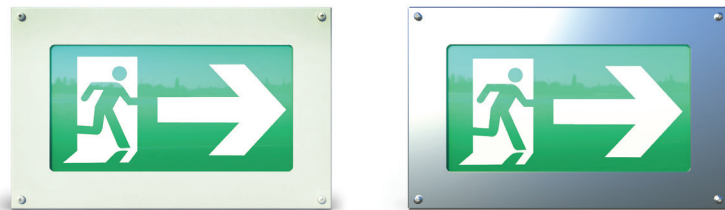

Available in standard white housing or chrome.



KEY FEATURES:

- ➔ Complies with BS5266-1 and conforms to EN60598.2.22 with IEC 60598-12014, ISO 30061, ISO 3864-1 & ISO 3864-4.
- ➔ Mild steel body.
- ➔ Long life SMD > 54,000+ hour LED version.
- ➔ Single sided use only.
- ➔ Available self-contained with 3 hour back-up battery.

EVACLITE

Bisley Two
Knightway House
Park Street
Bagshot, Surrey
GU19 5AQ

Email:

info@evaclite.com

Phone:

T. 01633 404999

Visit:

www.evaclite.com

SPECIFICATION

Self-contained dynamic edge-lit exit sign utilising an LED light source. Metal body suitable for use on smooth or rough wall surface types. ISO legend illumination compliant with the requirements of EN1838. Luminaire compliant to EN60598-2-22, ISO 30061, ISO 3864-1 & ISO 3864-4.

FIRE ALARM PANEL CONNECTIVITY

Evaclite Dynamic Exit Signs provide 2 x open volt free contacts and can be activated via a loop powered input/output relay module, supplied by your preferred choice of fire alarm panel manufacturer.

LAMP

Maintained State: <6W LED strip
Dynamic State: <7W LED arrays
Supply Voltage: 230v - 50Hz

MATERIALS

- Trim: Steel, powder coated in white.
- Legend panel: Perspex to BS476 part 7 Class 3, with pre-applied legend & in-built dynamic arrays.

BATTERY (self-contained versions)

4.8v 2100mAh Nimh

INSTALLATION NOTES

Can be installed onto rough or smooth walls via apertures in rear back box. The front fascia is secured by six M4 fixing screws at recommended torque.

SYSTEM MODE (LED)

Maintained

HOUSING

White as standard

HOUSING OPTIONS

- /CHR Chrome

WEIGHT

<3kg

DIMENSIONS (mm)

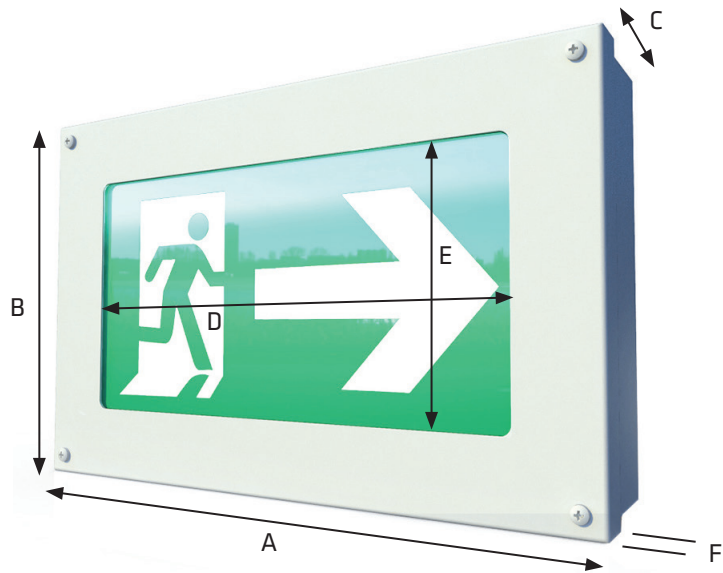

A=330, B=208, C=70, D=250, E=129, F=20

MAXIMUM VIEWING DISTANCE

Viewing distance of exit sign: 25 metres

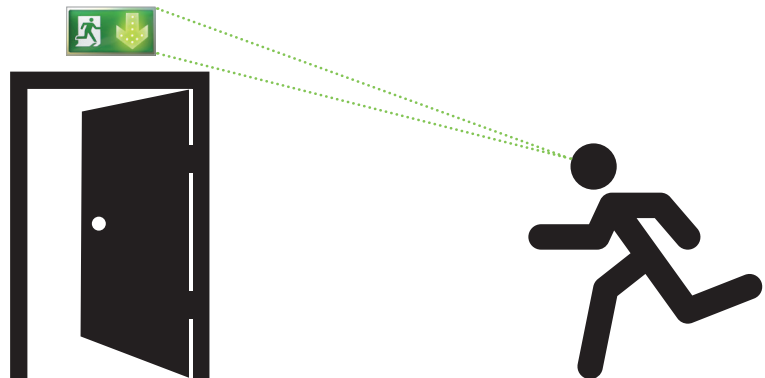

LEGEND PANEL

Legend Panel	ISO Pictogram	Cat no
Single sided arrow up		BCN/ADS/S/25/AU
Single sided arrow down		BCN/ADS/S/25/AD
Single sided arrow left		BCN/ADS/S/25/AL
Single sided arrow right		BCN/ADS/S/25/AR