

## VIENNA DYNAMIC BLADE

The Vienna is an aesthetically pleasing recessed maintained exit sign with conventional functionality plus extra performance and styling provided by the Evaclite ADS Adaptive/Dynamic LED 3PA Blade technology.

Installation is ideal for suspended and tightly attached ceiling structures due to its two rotating fixing arms that secure the housing in place across different thickness supporting surfaces, and two screw fittings for the visible fascia plate.



**1: ALARM**  
PASSIVE SIGN



**2: ALARM EVENT**  
DYNAMIC SIGN FOR  
SAFE EXIT



**3: ALARM EVENT**  
ADAPTIVE SIGN FOR  
UNSAFE EXIT

Available in standard white fascia and also in brass or a chrome effect.



### KEY FEATURES:

- ➔ Complies with BS5266-1 and conforms to EN60598.2.22 with IEC 60598-12014, ISO 30061, ISO 3864-1 & ISO 3864-4.
- ➔ Steel body suitable for use in solid or suspended ceiling types.
- ➔ Long life SMD > 54,000+ hour LED version.
- ➔ Suitable for single or double-sided use.
- ➔ Available in self-contained AC/DC with 3 hour back-up battery.

#### EVACLITE

Bisley Two  
Knightway House  
Park Street  
Bagshot, Surrey  
GU19 5AQ

**Email:**  
info@evaclite.com

**Phone:**  
T. 01633 404999

**Visit:**  
www.evaclite.com

### SPECIFICATION

Self-contained Dynamic edge-lit exit sign utilising an LED light source. Metal body suitable for use in suspended or tightly attached ceiling types. ISO legend illumination compliant with the requirements of EN1838. Luminaire compliant to EN60598-2-22, ISO 30061, ISO 3864-1 & ISO 3864-4.

### FIRE ALARM PANEL CONNECTIVITY

The Vienna Dynamic Exit Sign provides 2 x open volt free contacts and can be activated via a loop powered input/output relay module, supplied by your preferred choice of fire alarm panel manufacturer.

### LAMP

Maintained State: <6W LED strip  
Dynamic State: <7W LED arrays  
Supply Voltage: 230v - 50Hz

### MATERIALS

- Trim: Steel, powder coated in white.
- Legend panel: Perspex to BS476 part 7 Class 3, with pre-applied legend & in-built dynamic arrays.

### BATTERY (self-contained versions)

4.8v 2100mAh Nimh

### INSTALLATION NOTES

Suitable for suspended or tightly attached ceilings. Body is retained into ceiling by two suspension arms. The trim is secured to the body by M4 fixing screws.

### SYSTEM MODE (LED)

Maintained

### FASCIA PLATE

White as standard

### FASCIA PLATE OPTIONS

- /BRS Brass
- /CHR Chrome

### WEIGHT

<3kg

### DIMENSIONS (mm)

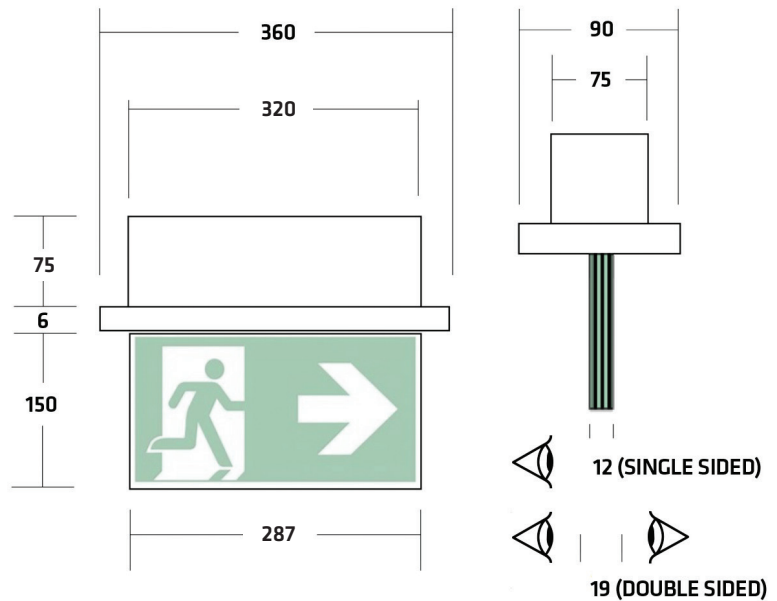

### MAXIMUM VIEWING DISTANCE

Viewing distance of exit sign: 24 metres

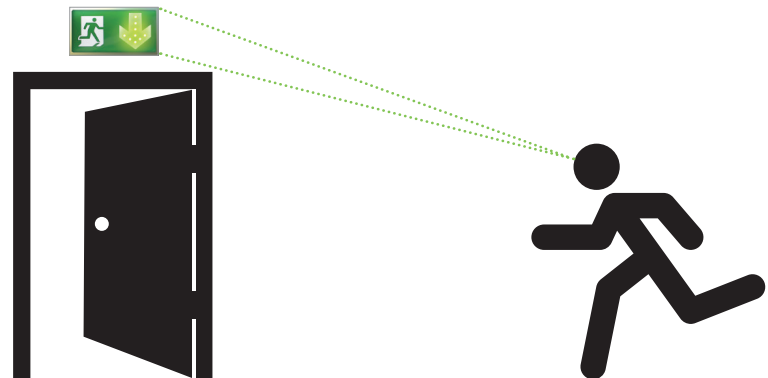

### LEGEND PANEL

Legend Panel	ISO Pictogram	Cat no
Single sided arrow up		VIE/ADS/S/24/AU
Single sided arrow down		VIE/ADS/S/24/AD
Single sided arrow left		VIE/ADS/S/24/AL
Single sided arrow right		VIE/ADS/S/24/AR
Double sided arrow left & right		VIE/ADS/S/24/ALR
Double sided arrow up		VIE/ADS/S/24/AU
Double sided arrow down		VIE/ADS/S/24/AD