

## CV9600(S)-X-XX Economic access control system

## CV9600T(S)-X-XX Dual access control + time attendance system

**CV9600(S)-X-XX** is economic access control terminal. **CV9600T(S)-X-XX** is access control terminal with [events recording](#) function. It's a contactless reading Mifare Secure Sector or read only (UID) device that supports ISO14443A Mifare.

The terminal features with stand-alone mode, network mode via RS485 or build-in TCP/IP; 512 cardholders can be registered, and event records reach up to 1,000 [CV9600T(S)-X-XX]; Work modes include Card only, PIN only, or Card + PIN with backlight keypad.

The terminal features toggle function, so the door could be opened for a specific period of time and closed by presenting card, it's suitable for frequent access place such as hotel, classroom, hospital, etc. It also features an external reader for anti-passing back (Wiegand port) for high security.

Powerful and friendly application software is offered for access control & time attendance solution with integrated user management, which is designed for single or network management on CV9600(S)-X-XX Terminal by simple one-click solution to literally get complete monthly T&A report for all users. SDK is also open for customer's further development in short time.

### ➤ The family members are:

#### Access Control

<a href="#">CV9600-X-0/1C</a>	Economic access control system, Card Only / Card + Pin, Mifare Secure Sector
<a href="#">CV9600-X-0D</a>	Mullion mount Economic access control system, Card Only, Mifare Secure Sector
<a href="#">CV9600-X-0/1F</a>	Anti-vandal access control system, Card Only / Card + Pin, Mifare Secure Sector
<a href="#">CV9600S-X-0/1C</a>	Economic access control system, Card Only / Card + Pin Mifare Serial Number Only
<a href="#">CV9600S-X-0D</a>	Mullion mount Economic access control system, Card Only, Mifare Serial Number only
<a href="#">CV9600S-X-0/1F</a>	Anti-vandal access control system, Card Only / Card + Pin, Mifare UID

#### Access Control with Time Attendance function

<a href="#">CV9600T-X-0/1C</a>	Dual Access control + time attendance, Card Only / Card + Pin, Mifare Secure Sector
<a href="#">CV9600T-X-0D</a>	Mullion mount Dual Access control + time attendance, Card Only, Mifare Secure Sector
<a href="#">CV9600T-X-0/1F</a>	Anti-vandal Dual Access control + time attendance system, Card Only / Card+Pin, Mifare Secure Sector
<a href="#">CV9600TS-X-0/1C</a>	Dual Access control + time attendance, Card Only / Card + Pin, Mifare Serial Number Only
<a href="#">CV9600TS-X-0D</a>	Mullion mount Dual Access control + time attendance, Card Only, Mifare Serial Number Only
<a href="#">CV9600TS-X-0/1F</a>	Anti-vandal Dual Access control + time attendance system, Card Only / Card + Pin, Mifare UID

### Advantages

- ✚ Stand-alone mode and network mode
- ✚ Vandal resistant for harsh environment (0F/1F casing)
- ✚ Guarantee that the record does not lose
- ✚ Adjust Controller time
- ✚ Dual function: access control with real time clock and 1,000 events [(CV9600T(S)-X-XX]
- ✚ Build-in TCP/IP interface optional for networking
- ✚ Up to 512 user, including one master card
- ✚ Card, Card + Pin, Pin mode
- ✚ External reader for anti-passing (Wiegand port)
- ✚ Housing sabotage alarm
- ✚ All I/Os and operating times user keypad programmable
- ✚ Toggle mode of door opening for a specific period of time, suitable for frequently in/out place [CV9600(T)(S)-X-1C]
- ✚ Self diagnostics
- ✚ Watch-dog timer & power on reset
- ✚ Duress alarm in case of emergency

**Order Code**

CV9600(T)(S)-X-XX

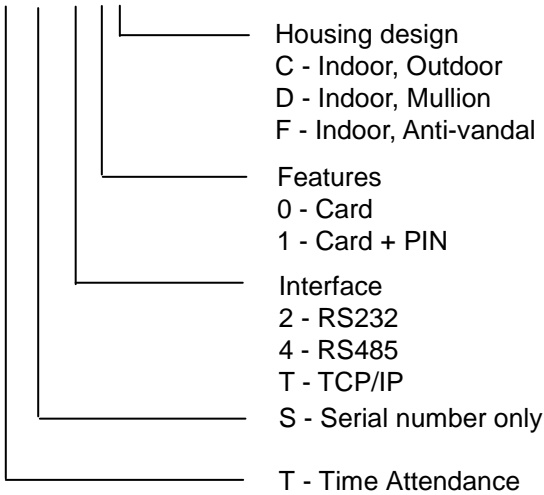

**Product Images**



**Specifications**

Model	CV9600(T)-X-XX	CV9600(T)S-X-XX
Supporting card	Mifare and other ISO14443A compatible card	
Read and write	Read data from user defined sector of Mifare card	Read only UID of Mifare and other ISO14443A card
Power Supply	9V DC (9-24V), <150mA	
Cardholder	512, including one master card	
Events	1,000 records with real time clock (RTC) <a href="#">[CV9600T(S)-X-XX]</a>	
Stand alone	Yes	
Network	Yes, via RS485 (up to 98 units) or build-in TCP/IP	
Communication	9600 -115200 bit/s (default 9600)	
APB	External Wiegand 26/34 reader	
Operation Mode	Card, Card + Pin, Pin	
Memory	32K Byte EEPROM	
Alarm	Door non-closed detection; Door broken alarm; Housing sabotage alarm; Duress alarm in case of emergency	
Keypad	3*4 keypads with backlight	
Input device	2 inputs (exit button, door state sensor)	
Output device	2 relay outputs	
Reading distance	50mm (depending on transponder)	
Indicators	Buzzer and LED	
Housing Material	PC for CV9600(T)(S)-X-0D, Zn-Fe alloy for CV9600(T)(S)-X-0/1F, others ABS	
Indoor / outdoor	Both, potted version (IP65) available on request	
Temperature range	-20°C ~ +60°C / -4°F ~ +140°F	
Relative humidity	10-95% (non condensing)	

Specifications are subject to change without notice.

## Configuration

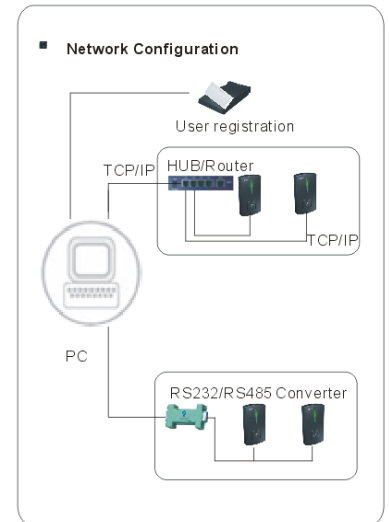
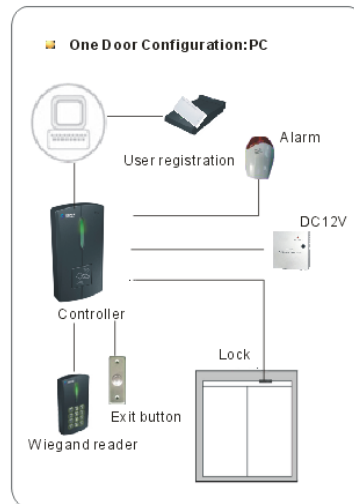
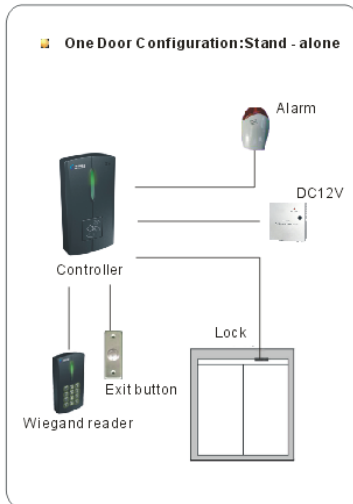

## Relative Products



### Software Development Kit

IOAccess SDK is software development kit worked with CiVinTec Access Control & TA terminal for second development. It includes API, Host Demo, user manual and program example. It's developed by C++builder developing tool on Windows Operating system and GCC developing tool on Linux OS, compatible to VC,VB/VB.NET,JAVA,C++,C#.NET, DELPHI etc.



### Access Control & Time Attendance Software

- Access Control Software features to control network of Civintec devices by easy connectivity with PC. It's easy operation suitable for small-to-large sized organizations.
- Time Attendance Software is designed for one-click solution to literally get complete monthly T&A reports for all users. Data can be exported for further processing.



### Hardware Testing Package (HTP)

A plug & play Hardware Testing Package (HTP) is provided to ease your fast testing and evaluation. Package list:

- Testing Board
- Power supplier
- RS232 cable
- Wire cable
- Internet cable
- Testing Cards
- RS232 / RS485 converter



### Relative Hardware

- CV9600(S)-X-XX Serial Number series can register a few number cards on stand-alone application, and professional desktop reader CN6XX is required for card batch issuing on stand-alone or network application. CN6XX is required for card programming on stand alone or network application
- Full range of cards and tags available to meet complete solution